

RATCHET WRENCHES

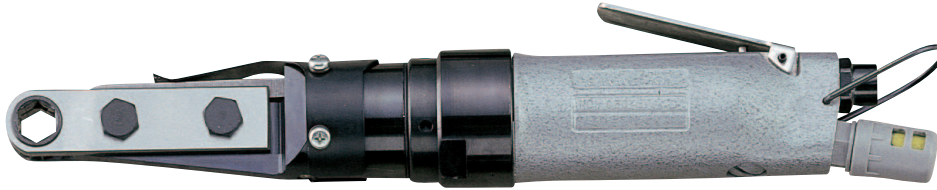

URW-8



URW-6



URW-12N



URW-8N



URW-12NB



URW-10N

FEATURES

Most suitable for fastening in narrow application. Bent head type, Thinner head type and Extended head type are also available for hard-to-reach access fastening jobs.

Reverse rotation is obtained by simply turning a tool over.

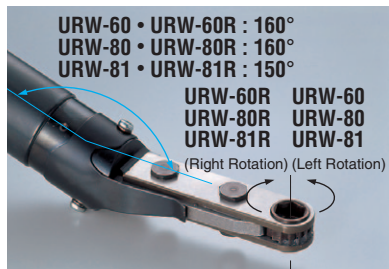

Head Sizes

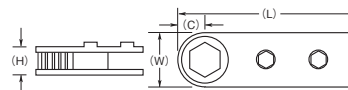

Model	H		W		L		C	
	mm	in	mm	in	mm	in	mm	in
URW-6,60,60R	13.0	33/64	20.0	25/32	88.0	3 15/32	10.0	25/64
URW-8,8N,9N,80,80R,81,81R	18.0	45/64	25.0	63/64	102.5	4 1/32	12.5	31/64
URW-10N	18.0	45/64	33.0	1 19/64	106.5	4 3/16	16.5	21/32
URW-12N	18.0	45/64	36.0	1 27/64	109.5	4 5/16	18.0	45/64
URW-12NA	18.0	45/64	46.0	1 13/16	120.5	4 3/4	23.0	29/32
URW-12NB	18.0	45/64	54.0	2 1/8	128.5	5 1/16	27.0	1 1/16

SPECIFICATIONS

Recommended Air Pressure : 0.4MPa (57psi)

Model	Capacity (Nominal Bolt Size)		Max. Torque		Free Speed (about)	Overall Length (about)		Weight (about)		Hex. Size of Ratchet		Average Air Consumption		Code
	mm	in	Nm	ft-lbs		mm	in	kg	lb	mm	in	m ³ /min	ft ³ /min	
URW-6	6	1/4	11	8.1	210	292	11 1/2	1.15	2.53	6, 7, 8, ⑩, 11, 12	1/4, 5/16, 3/8, 7/16	0.28	9.9	20052
URW-60	6	1/4	11	8.1	210	288	11 11/32	1.15	2.53	6, 7, 8, ⑩, 11, 12	1/4, 5/16, 3/8, 7/16	0.28	9.9	20082
URW-60R	6	1/4	11	8.1	210	288	11 11/32	1.15	2.53	6, 7, 8, ⑩, 11, 12	1/4, 5/16, 3/8, 7/16	0.28	9.9	20092
URW-8N	8	5/16	16	11.8	260	300	11 13/16	2.25	4.95	7, 8, 9, 10, 11, 12, 13, ⑭, 15	7/16, 1/2, 9/16	0.55	19.5	21212
URW-80	8	5/16	16	11.8	240	300	11 13/16	2.25	4.95	7, 8, 9, 10, 11, 12, 13, ⑭, 15	7/16, 1/2, 9/16	0.55	19.5	22912
URW-80R	8	5/16	16	11.8	240	300	11 13/16	2.25	4.95	7, 8, 9, 10, 11, 12, 13, ⑭, 15	7/16, 1/2, 9/16	0.55	19.5	22962
URW-81	8	5/16	16	11.8	240	300	11 13/16	2.25	4.95	7, 8, 9, 10, 11, 12, 13, ⑭, 15	7/16, 1/2, 9/16	0.55	19.5	23112
URW-81R	8	5/16	16	11.8	240	300	11 13/16	2.25	4.95	7, 8, 9, 10, 11, 12, 13, ⑭, 15	7/16, 1/2, 9/16	0.55	19.5	23162
URW-8	8	5/16	16	11.8	240	360	14 3/16	1.90	4.18	7, 8, 9, 10, 11, 12, 13, ⑭, 15	7/16, 1/2, 9/16	0.56	19.8	20152
URW-9N	10	3/8	31	22.9	140	380	15	2.35	5.17	7, 8, 9, 10, 11, 12, 13, ⑭, 15	7/16, 1/2, 9/16	0.67	23.7	22742
URW-10N	10	3/8	57	42.2	155	394	15 33/64	2.65	5.83	10, 12, 13, 14, 15, 16, ⑰, 18, 19	9/16, 5/8, 11/16, 3/4	0.70	25.0	21412
URW-12N	13	1/2	59	43.7	145	397	15 5/8	2.70	5.94	12, 14, 16, 17, 18, 19, ⑳, 22, 23	3/8, 1/2, 9/16, 5/8, 11/16, 3/4, 13/16	0.70	25.0	21512
URW-12NA	14	9/16	78	57.7	105	408	16 1/16	2.80	6.16	17, 18, 19, 21, 22, 23, ㉑, 26, 27	11/16, 3/4, 15/16	0.70	25.0	21612
URW-12NB	16	5/8	93	68.8	90	416	16 19/64	2.90	6.38	24, 29, ㉒, 32	5/8, 11/16, 3/4, 13/16, 7/8, 15/16, 1, 1-1/8	0.70	25.0	21812

Air Inlet Thread (Pipe Tap) : NPT1/4"

Air Hose Size (Inside Diameter) : 9.5mm (3/8")

Code mentioned in the above list comes with the standard Hex size of ratchet circled ○. Specify Hex. size when ordering.

Max Torque is a guideline at 0.6MPa.