

UCC SERIES

UCC-100Z

Multifunctional Coordinator with built-in Wireless unit for UBX-AF Series



UCC SERIES SPECIFICATIONS

MODEL	UCC-100Z
POWER SUPPLY	AC 100-240V ±10%
POWER FREQUENCY	50/60 Hz
INSULATION PROTECTION	DC500V over 10MΩ
POWER CONSUMPTION	35VA
WEIGHT	2.9kg
DIMENSIONS	Without antenna 254(D)×222(W)×99(H) / With antenna 254(D)×233.5(W)×106(H)
MAIN FUNCTIONS	Torque Control / Angle Monitoring / Fastening Counter
PARAMETER SETUP	Manual Input on LCD Panel / Personal Computer (with setup software)
DISPLAY	Torque Resolution ±2048 (12Bit A/D) LCD: 20 Characters×8 lines Contents: WORK NO. / FASTENING COUNT DOWN NO. / FASTENING TIME / PULSE NO. / ANGLE / ERROR MESSAGE
LAMP	COUNT LAMP: OK (Green) / NOK (Red) FASTENING LAMP: LOW (Yellow) / OK (Green) / HIGH (Red)
INPUT TERMINAL SIGNAL	Operation Voltage / Current: DC24V / approx. 10mA, 6 Terminals (free format) Note: Contact input necessary
OUTPUT TERMINAL SIGNAL	Contact Capacity: DC30V, 1A, 6 Terminals (free format)
OPTION	Setting PC Cable (Straight) Part Number: 910-219-0
CODE (A/E)	81Z12/81Z02

UCC-100Z

UBX-AF Series

UCC-100Z Series System Layout

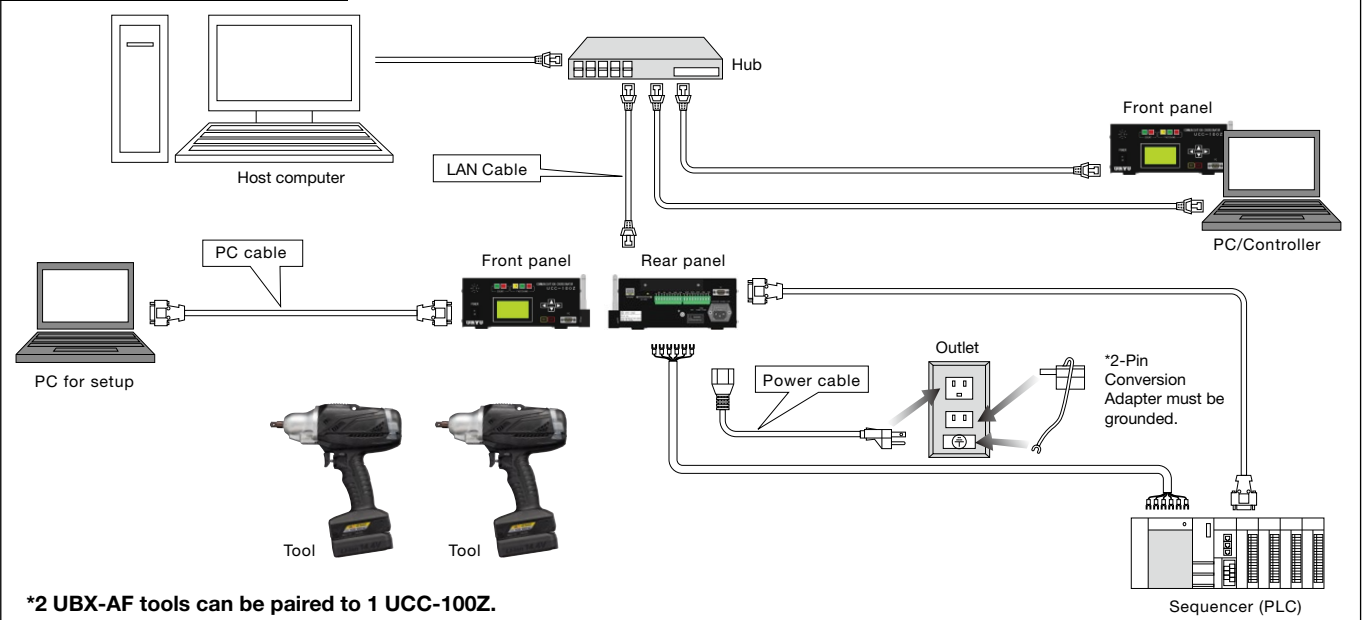

*2 UBX-AF tools can be paired to 1 UCC-100Z.

UBX-AF SERIES

Best Performance Battery Tools equipped with Newly Developed PHOENIX pulse, Auto-Relief and Torque & Angle Sensor

BOLT & NUT SETTERS



UBX-AF500Z



UBX-AF600Z



UBX-AF700Z

* For information on the Radio Law in your country, please contact your nearest URYU distributor.

FEATURE

New design with No springs helps to overcome challenges with conventional pulse tools.

- More powerful
- Minimizes temperature increase
- No need to warm up before use

Improved Durability

Low oil pressure inside the pulse unit reduces the pressure against sealing, which minimizes oil leakage.

Newly designed Auto-Relief (PAT.P) is not affected by oil degradation.

Upsized LED lamp enables operators to judge OK/NOK easily in any posture.



Pairing parameter is selectable from 3 types;

1. Manual Pairing by dip switches
2. Pairing through software
3. Wireless pairing

Fastening parameters are memorized in UCC-100Z coordinator. Quick tool change only by pairing!

Specifications

Model	Capacity (Nominal Bolt Size)		Torque Range		Free Speed (Approx.)	Overall Length less Socket or Bit (Approx.)		Weight less Socket or Bit				From Center to Outside (Approx.)		Sq. Drive or Hex. Size		Battery Voltage (Capacity)	Battery Model (Panasonic)	Number of fastening per minute *	Fastener quantity per full charge	Code
	mm	in	Nm	ft-lbs		min ⁻¹	mm	in	with battery		with no battery		mm	in	mm					
								kg	lb	kg	lb	mm	in	mm	in					
UBX-AF500Z	6-8	1/4-5/16	5.0-20.0	3.7-14.8	3600	219	8 5/8	1.82	4.01	1.52	3.35	29.5	1 5/32	9.5	3/8	10.8V(2.0Ah)	EYFB32	11	440	12A12
UBX-AF600Z	8-10	5/16-3/8	15.0-40.0	11.1-29.5	4800	219	8 5/8	1.87	4.12	1.52	3.35	29.5	1 5/32	9.5	3/8	14.4V(2.0Ah)	EYFB41	10	320	12A32
UBX-AF700Z	8-12	5/16-1/2	25.0-60.0	18.4-44.3	4800	219	8 5/8	1.91	4.21	1.56	3.44	29.5	1 5/32	9.5	3/8	14.4V(2.0Ah)	EYFB41	9	320	12A52

*Torque Range is a guideline value. Please make tool selection appropriately in accordance with an actual application.

*Battery or Battery Charger is not included. Please use EY0L82 (Panasonic) for Battery Charger.

*Calculated under URYU test condition. It varies depending on the usage condition.

UBX-T SERIES [SHUT-OFF TYPE]

Premium Type Battery Oil-Pulse Tool equipped with PHOENIX Pulse Unit and Auto-Relief



UBX-T70



UBX-T70 (RF8)

FEATURE

- Weight Reduced by 20% & Overall Length Downsized by 47mm (*Compared with UDBP-TA70(P))
- Newly developed diaphragm improves fastening accuracy by sensing inner pressure of the pulse unit precisely.
- Incomplete Job Error Detection function (TK) is standardized.
- Improvement of operator's visual confirmation by LED lamp for fastening judgement

Wireless RF8 Type / Z(ZigBee) Type (*)

*For information on the Radio Law in your country, please contact your nearest URYU distributor.

RF8 : Pokayo configuration

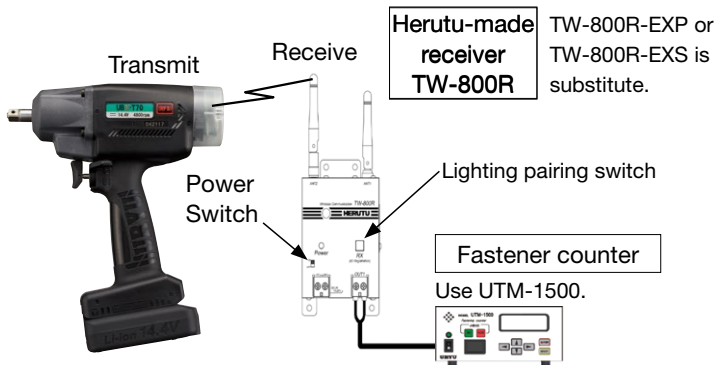

Z(ZigBee) : Pokayo configuration

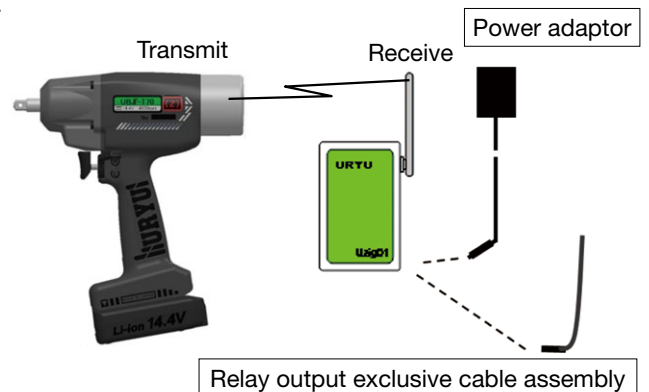

To UTM-1500 or PLC

Specifications (Shut-off Type)

Model	Capacity (Nominal Bolt Size)		Torque Range		Free Speed (Approx.)	Overall Length less Socket or Bit (Approx.)		Weight less Socket or Bit				From Center to Outside (Approx.)		Sq. Drive or Hex. Size	Battery Voltage (Capacity)	Battery Model (Panasonic)	Number of fastening per minute *	Fastener quantity per full charge	Code	
	mm	in	Nm	ft-lbs		mm	in	with battery		with no battery		mm	in							
	kg	lb	kg	lb	min ⁻¹	mm	in	kg	lb	kg	lb	mm	in							
UBX-T70	8-12	5/16-1/2	25.0-55.0	18.5-40.7	4800	187	7 23/64	1.63	3.59	1.28	2.82	27.5	1 3/32	9.5	3/8	14.4V(2.0Ah)	EYFB41	8	250	12F02
								1.86	4.10	1.28	2.82									
UBX-T70(RF8)	8-12	5/16-1/2	25.0-55.0	18.5-40.7	4800	193	7 19/32	1.63	3.59	1.28	2.82	27.5	1 3/32	9.5	3/8	14.4V(2.0Ah)	EYFB41	8	250	12F22
								1.86	4.10	1.28	2.82									
UBX-T70(Z)	8-12	5/16-1/2	25.0-55.0	18.5-40.7	4800	204	8 1/32	1.63	3.59	1.28	2.82	27.5	1 3/32	9.5	3/8	14.4V(2.0Ah)	EYFB41	8	250	12F32
								1.86	4.10	1.28	2.82									

*Torque Range is a guideline value. Please make tool selection appropriately in accordance with an actual application.

*Battery or Battery Charger is not included. Please use EY0L82 (Panasonic) for Battery Charger.

*Calculated under URYU test condition. It varies depending on the usage condition.

OPTION

Optional Tool Jackets

Part Number	Used for
12F-840-0	UBX-T70
12F-840-1	UBX-T70(RF8)
12F-840-3	UBX-T70(Z)

BP-T SERIES [SHUT-OFF TYPE]

Evolving Battery Oil Pulse Tool BP-T series

BOLT & NUT SETTERS



BP-T40D



BP-T50D



BP-T60D



BP-T60

FEATURES

- New grip style in terms of operator's comfort. It protects operator from fatigue.
- Independent cooling fan reduces heat of pulse unit contributing to comfortable operation.
- Compact & High-capacity Li-ion battery provides more fasteners per charge.

Quick-change driver anvil type

On pulling the sleeve, insert or take off the bit.

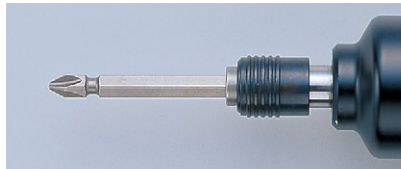
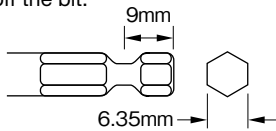

The model name suffixing (D) is the Quick-change driver anvil type.

Specifications (Shut-off Type)

Model	Capacity (Nominal Bolt Size)		Torque Range		Free Speed (Approx.)	Overall Length less Socket or Bit (Approx.)		Weight less Socket or Bit				From Center to Outside (Approx.)		Sq. Drive or Hex. Size		Battery Voltage (Capacity)	Battery Model (Panasonic)	Number of fastening per minute *	Fastener quantity per full charge	Code
	mm	in	Nm	ft-lbs		mm	in	with battery		with no battery		mm	in	mm	in					
	kg	lb	kg	lb	mm	in	mm	in												
BP-T40D	5	No. 10	4.5-8	3.3-5.9	3300	200	7 7/8	1.4	3.08	1.15	2.53	27	1 1/16	6.35	1/4	10.8V (2.0Ah)	EYFB32	11	1000	10A02
BP-T50D	6-8	1/4-5/16	6.5-13	4.8-9.6	3900	200	7 7/8	1.4	3.08	1.15	2.53	27	1 1/16	6.35	1/4	10.8V (2.0Ah)	EYFB32	7	700	10C02
BP-T60D	8	5/16	13-26	9.6-19.2	4800	205	8 5/64	1.6	3.52	1.25	2.75	27	1 1/16	6.35	1/4	14.4V (2.0Ah)	EYFB41	7	600	10E02
BP-T40	5	No. 10	4.5-8	3.3-5.9	3300	197	7 4/3	1.4	3.08	1.15	2.53	27	1 1/16	9.5	3/8	10.8V (2.0Ah)	EYFB32	11	1000	10A12
BP-T50	6-8	1/4-5/16	7-15	5.1-11.1	3900	197	7 4/3	1.4	3.08	1.15	2.53	27	1 1/16	9.5	3/8	10.8V (2.0Ah)	EYFB32	7	700	10C12
BP-T60	8	5/16	13-26	9.6-19.2	4800	202	7 61/64	1.6	3.52	1.25	2.75	27	1 1/16	9.5	3/8	14.4V (2.0Ah)	EYFB41	7	600	10E12

*Torque Range is a guideline value. Please make tool selection appropriately in accordance with an actual application.

*Battery or Battery Charger is not included. Please use EY0L82 (Panasonic) for Battery Charger.

*Calculated under URYU test condition. It varies depending on the usage condition.

OPTION

Protector



Optional Tool Jackets

Size	Part Number	Used for
S	10C-840-1	BP-T40(D), BP-T50(D) BP-T40(D)(RF8)/(TK), BP-T50(D)(RF8)/(TK) BP-T40(D)(Z), BP-T50(D)(Z)
	10C-840-4	
	10D-840-2	
M	10E-840-1	BP-T60(D) BP-T60(D)(RF8)/(TK) BP-T60(D)(Z)
	10E-840-4	
	10F-840-2	

DERIVATIVE MODELS OF BP-T SERIES [SHUT-OFF TYPE]

Wireless RF8 Type / Z(ZigBee) Type (*)

*For information on the Radio Law in your country, please contact your nearest URYU distributor.

RF8 : Pokayoko configuration

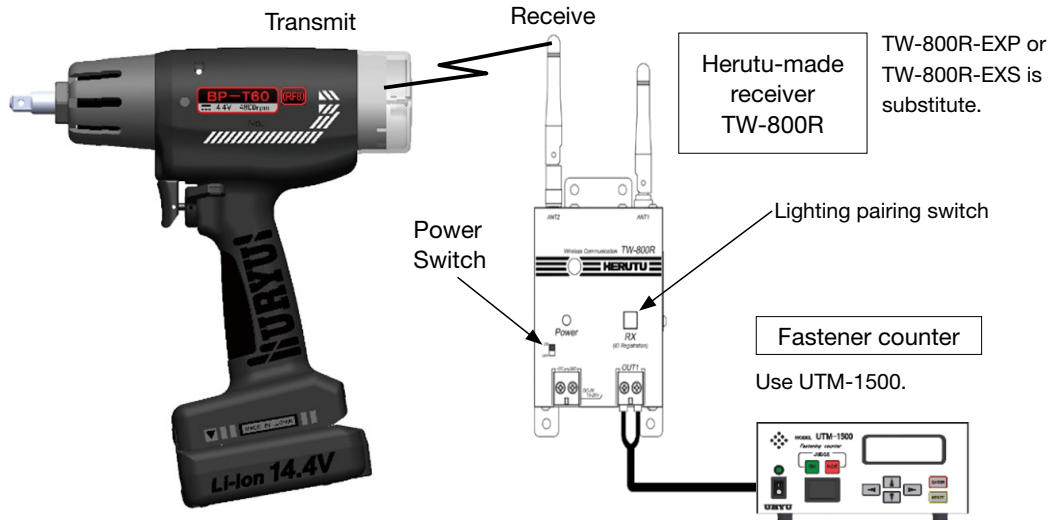

Z(ZigBee) : Pokayoko configuration

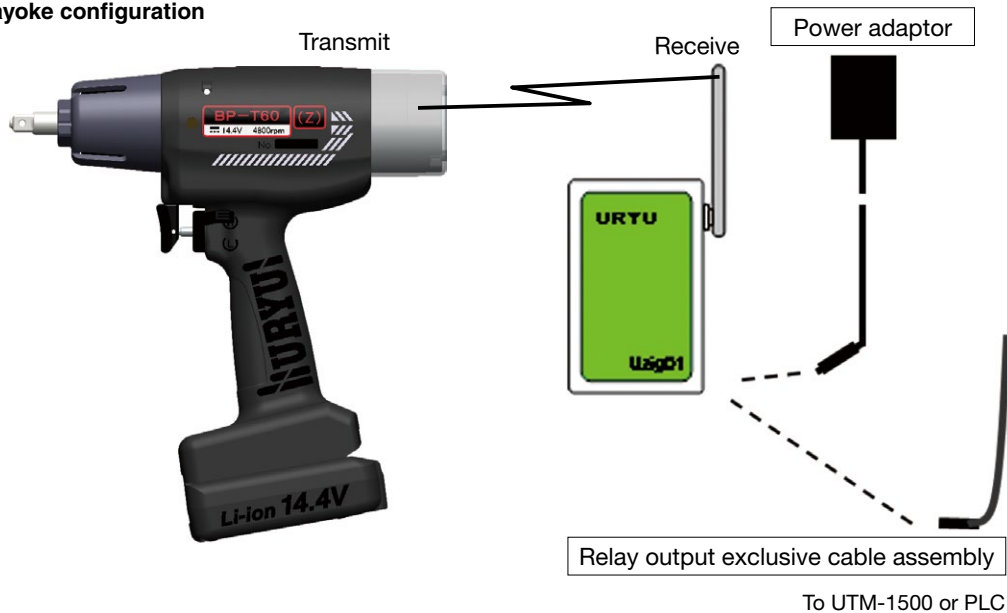

Specifications (Shut-off Type)

Model	Capacity (Nominal Bolt Size)		Torque Range		Free Speed (Approx.)	Overall Length less Socket or Bit (Approx.)		Weight less Socket or Bit				From Center to Outside (Approx.)		Sq. Drive or Hex. Size		Battery Voltage (Capacity)	Battery Model (Panasonic)	Number of fastening per minute *	Fastener quantity per full charge	Code
	mm	in	Nm	ft-lbs		mm	in	with battery		with no battery		mm	in	mm	in					
BP-T40D(RF8)	5	No. 10	4.5-8	3.3-5.9	3300	207	8 5/32	1.4	3.08	1.15	2.53	27	1 1/16	6.35	1/4	10.8V (2.0Ah)	EYFB32	11	1000	10A62
BP-T50D(RF8)	6-8	1/4-5/16	6.5-13	4.8-9.6	3900	207	8 5/32	1.4	3.08	1.15	2.53	27	1 1/16	6.35	1/4	10.8V (2.0Ah)	EYFB32	7	700	10C62
BP-T60D(RF8)	8	5/16	13-26	9.6-19.2	4800	212	8 11/32	1.6	3.52	1.25	2.75	27	1 1/16	6.35	1/4	14.4V (2.0Ah)	EYFB41	7	600	10E62
BP-T40(RF8)	5	No. 10	4.5-8	3.3-5.9	3300	204	8 1/32	1.4	3.08	1.15	2.53	27	1 1/16	9.5	3/8	10.8V (2.0Ah)	EYFB32	11	1000	10A72
BP-T50(RF8)	6-8	1/4-5/16	7-15	5.1-11.1	3900	204	8 1/32	1.4	3.08	1.15	2.53	27	1 1/16	9.5	3/8	10.8V (2.0Ah)	EYFB32	7	700	10C72
BP-T60(RF8)	8	5/16	13-26	9.6-19.2	4800	209	8 15/64	1.6	3.52	1.25	2.75	27	1 1/16	9.5	3/8	14.4V (2.0Ah)	EYFB41	7	600	10E72
BP-T40D(Z)	5	No. 10	4.5-8	3.3-5.9	3300	218	8 37/64	1.4	3.08	1.15	2.53	27	1 1/16	6.35	1/4	10.8V (2.0Ah)	EYFB32	11	1000	10B12
BP-T50D(Z)	6-8	1/4-5/16	6.5-13	4.8-9.6	3900	218	8 37/64	1.4	3.08	1.15	2.53	27	1 1/16	6.35	1/4	10.8V (2.0Ah)	EYFB32	7	700	10D12
BP-T60D(Z)	8	5/16	13-26	9.6-19.2	4800	223	8 25/32	1.6	3.52	1.25	2.75	27	1 1/16	6.35	1/4	14.4V (2.0Ah)	EYFB41	7	600	10F12
BP-T40(Z)	5	No. 10	4.5-8	3.3-5.9	3300	215	8 15/32	1.4	3.08	1.15	2.53	27	1 1/16	9.5	3/8	10.8V (2.0Ah)	EYFB32	11	1000	10B22
BP-T50(Z)	6-8	1/4-5/16	7-15	5.1-11.1	3900	215	8 15/32	1.4	3.08	1.15	2.53	27	1 1/16	9.5	3/8	10.8V (2.0Ah)	EYFB32	7	700	10D22
BP-T60(Z)	8	5/16	13-26	9.6-19.2	4800	220	8 21/32	1.6	3.52	1.25	2.75	27	1 1/16	9.5	3/8	14.4V (2.0Ah)	EYFB41	7	600	10F22

*Torque Range is a guideline value. Please make tool selection appropriately in accordance with an actual application.

*Battery or Battery Charger is not included. Please use EYOL82 (Panasonic) for Battery Charger.

*Calculated under URYU test condition. It varies depending on the usage condition.

BP-T SERIES [SHUT-OFF TYPE]

Incomplete Job Detection (TK) Type

LED with red lighting tells you incomplete job (premature trigger off)

BOLT & NUT SETTERS



BP-T60D (TK)

FEATURES

- Squeeze trigger, and shut-off information LED will light red.
- Switch off the trigger before automatic shut-off, and the LED will continue lighting red for 3 seconds and go out.
- The LED lights green with 1 pulse buzzer sounding for automatic shut-off.

(Note) Automatic shut-off by retry repairing incomplete job error will light LED by switching green and red together.

Quick-change driver anvil type

On pulling the sleeve, insert or take off the bit.

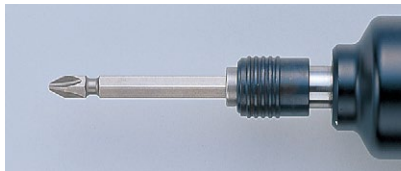
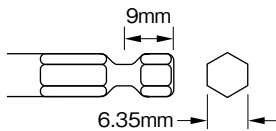

The model name suffixing (D) is the Quick-change driver anvil type.

Specifications (Shut-off Type)

Model	Capacity (Nominal Bolt Size)		Torque Range		Free Speed (Approx.) min ⁻¹	Overall Length less Socket or Bit (Approx.)		Weight less Socket or Bit				From Center to Outside (Approx.)		Sq. Drive or Hex. Size		Battery Voltage (Capacity)	Battery Model (Panasonic)	Number of fastening per minute *	Fastener quantity per full charge	Code
	mm	in	Nm	ft-lbs		mm	in	with battery		with no battery		mm	in	mm	in					
								kg	lb	kg	lb									
BP-T40D(TK)	5	No. 10	4.5-8	3.3-5.9	3300	207	8 5/32	1.4	3.08	1.15	2.53	27	1 1/16	6.35	1/4	10.8V (2.0Ah)	EYFB32	11	1000	10A82
BP-T50D(TK)	6-8	1/4-5/16	6.5-13	4.8-9.6	3900	207	8 5/32	1.4	3.08	1.15	2.53	27	1 1/16	6.35	1/4	10.8V (2.0Ah)	EYFB32	7	700	10C82
BP-T60D(TK)	8	5/16	13-26	9.6-19.2	4800	212	8 11/32	1.6	3.52	1.25	2.75	27	1 1/16	6.35	1/4	14.4V (2.0Ah)	EYFB41	7	600	10E82
BP-T40(TK)	5	No. 10	4.5-8	3.3-5.9	3300	204	8 1/32	1.4	3.08	1.15	2.53	27	1 1/16	9.5	3/8	10.8V (2.0Ah)	EYFB32	11	1000	10A92
BP-T50(TK)	6-8	1/4-5/16	7-15	5.1-11.1	3900	204	8 1/32	1.4	3.08	1.15	2.53	27	1 1/16	9.5	3/8	10.8V (2.0Ah)	EYFB32	7	700	10C92
BP-T60(TK)	8	5/16	13-26	9.6-19.2	4800	209	8 15/64	1.6	3.52	1.25	2.75	27	1 1/16	9.5	3/8	14.4V (2.0Ah)	EYFB41	7	600	10E92

*Torque Range is a guideline value. Please make tool selection appropriately in accordance with an actual application.

*Battery or Battery Charger is not included. Please use EYOL82 (Panasonic) for Battery Charger.

*Calculated under URYU test condition. It varies depending on the usage condition.