

UECP SERIES

The UECP series Controller becomes one unit combined driver unit to drive UDP-MC series electric oil pulse tools and multi-function controller of UEC-4810 to control a transducerized tool.

BOLT & NUT SETTERS



*Joint Cable Assembly is necessary to connect tool with controller
 For UDP-A600LMC · A700MC · A100MC 910-517-0: 5M / 910-518-0: 10M / 910-519-0: 15M / 910-624-0: 20M
 For UDP-A120MC 910-567-0: 5M / 910-568-0: 10M / 910-569-0: 15M / 910-625-0: 20M

UECP SERIES SPECIFICATIONS

POWER SUPPLY	UECP-4810A: AC115V UECP-4810E: AC230V
POWER FREQUENCY	50 / 60 Hz
NOISE PROTECTION	1000V 1μS (according to noise simulator)
INSULATION PROTECTION	DC500V over 10MΩ
AMBIENT TEMPERATURE	0 ~ 50°C (non-freezing)
AMBIENT HUMIDITY	90% RH or less (no dew)
WEIGHT	11.30 kg
DIMENSIONS	265 (D) × 222 (W) × 200 (H)
MAIN FUNCTIONS	Torque control, Torque monitor Fastener number count
PARAMETER SETUP	Manual input on front LCD panel By PC (with setup software)
DISPLAY	Torque resolution ±2048 (12 bit by A/D use)
	LCD type LCD (20 letters × 4 lines)
	Work number, Bolt count number, Tightening time and Pulse blow number 1-digit Digital Display (DPM) Work number displayed 4-digit Digital Display (DPM) Torque reading displayed
LED	Total Lamp (for Count Judgment) : OK (green) / NOK (red)
	Torque Lamp (for Torque Judgment) : LOW (yellow) / OK (green) / HIGH (red)
INPUT TERMINAL SIGNAL	Operation Voltage/Current : DC24V / about 10mA 6 terminals available (programmable) Note: Contact input necessary
OUTPUT TERMINAL SIGNAL	Contact Capacity : DC30V, 1A 6 terminals available (programmable), VALVE
OPTION	Setting PC Cable (Straight) Part Number : 910-219-0
CODE (A/E)	81862/81872

UECP-4810 | UDP-A600LMC · A700MC · A100 · A120 MC Series

UECP Series System Layout

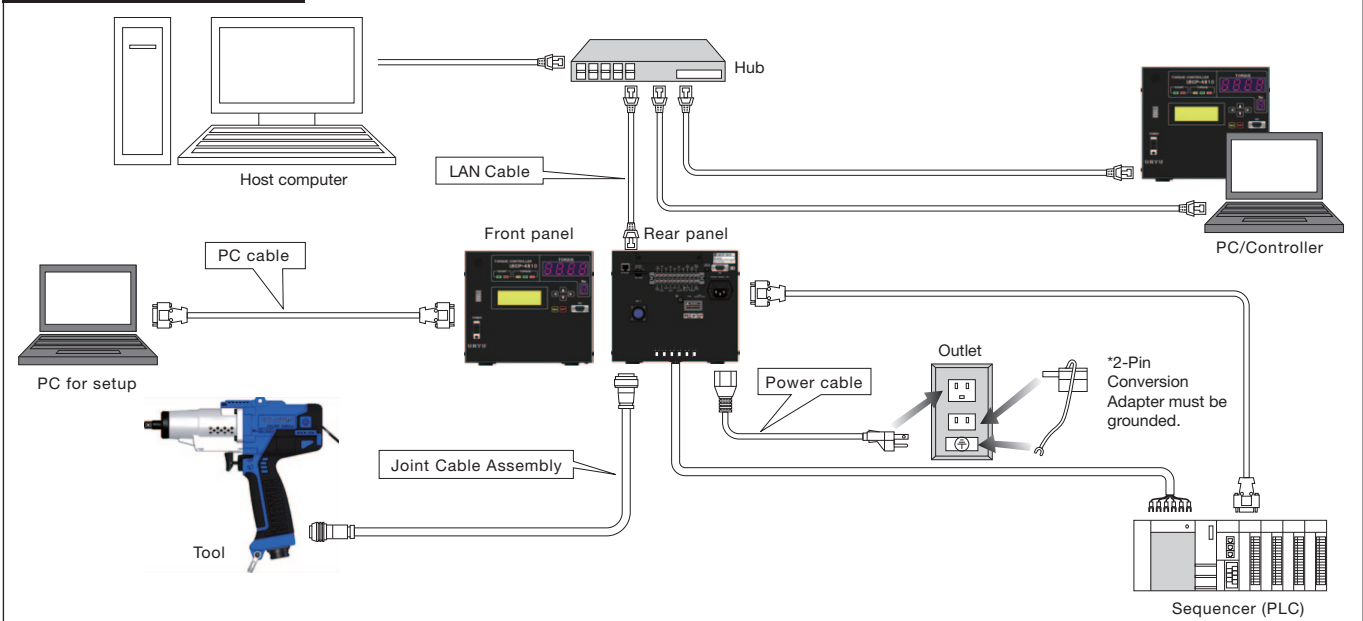

UDP-MC SERIES

**Exquisite Range of Torque.
Fastening with high efficiency & high accuracy.
New Function: Double hitting error detection function available.
External start signal available for multi-purpose usage.**



UDP-A700MC



UDP-A600LMC

UDP-A100MC
UDP-A120MC

Top Load Type

UDP-A600LMC (TL)

FEATURES

- URYU's unique non-contact Magnetostrictive transducer incorporated. (Refer to P. 7.)
- The UDP tool is driven by commercial electricity. This helps you build an assembly line easily and adjust it flexibly to the layout change.
- High Power and High efficiency adopted by IPM motor. (except for A100MC/A120MC)
- Cooling fan is activated automatically when pulling the throttle trigger, which contributes to heat reduction and increase number of fastening.
- URYU know-how acquired from the pneumatic oil-pulse tool development, and newly developed "Auto Relief Function" (PAT.) is adopted.
- The intelligence of UDP-MC tool stops operation immediately to protect the operator from the failure including overloaded operation, short circuit, and broken wire, which minimizes the possible influence over operator and shop floor.

[FUNCTIONS]

- Motor speed/current is programmable.
 - Motor current can be set in 4 steps
 - Motor rotational speed can be set in 100 rpm increments (by the 2-step fastening, torque spike at bolt seating is inhibited, and make it possible to cover the wider torque range.)
- The functions of various fastening error detections and fastener number count down assure your operations.
- Makes setup or changeover of fastening torque and fastening number count.
- Tool's maintenance is possible by counting both total cycle numbers (how many fasteners) and/or total pulse numbers.
- Input/Output check and error messages can be checked from your PC screen or the front panel of UECP Series with buzzer sounding.
- Can set up and monitor various control values and setting values either on the front panel or on your PC screen.
- Ethernet(TCP/IP) capable. Upload and receipt of the setting values, upload of the fastening result/waveform data through PC software.

Electric Oil-Pulse Tool UDP-MC Series

Model	Capacity (Nominal Bolt Size)		Torque Range		Free Speed (Approx.) rpm	Overall Length (about)		Weight less Socket or Bit (about)		From Center to Outside (about)		Sq. Drive or Hex. Size		Code	
	mm	in	Nm	ft-lbs		mm	in	kg	lb	mm	in	mm	in	Standard	TL
UDP-A600LMC, (TL)	5-6	No.10-1/4	4-20	3.0-14.8	4800	214	8 27/64	1.53	3.37	29.5	1 5/32	9.5	3/8	07452	07459
UDP-A700MC, (TL)	8-12	5/16-1/2	10-50	7.4-37.0	4800	242	9 33/64	1.78	3.92	29.5	1 5/32	9.5	3/8	07332	07339
UDP-A100MC, (TL)	10-12	3/8-1/2	45-100	33.3-74.0	4800	248	9 49/64	2.85	6.27	34.5	1 23/64	12.7	1/2	07382	07389
UDP-A120MC, (TL)	10-12	3/8-1/2	55-120	40.5-88.4	4800	248	9 49/64	2.85	6.27	34.5	1 23/64	12.7	1/2	07402	07409

Model name with "TL" is top load type.

*Torque Range is a guideline value. Please make tool selection appropriately in accordance with an actual application.