

BP-T SERIES [SHUT-OFF TYPE]

Evolving Battery Oil Pulse Tool BP-T series

BOLT & NUT SETTERS



BP-T40D



BP-T50D



BP-T60D



BP-T60

FEATURES

- New grip style in terms of operator's comfort. It protects operator from fatigue.
- Independent cooling fan reduces heat of pulse unit contributing to comfortable operation.
- Compact & High-capacity Li-ion battery provides more fasteners per charge.

Quick-change driver anvil type

On pulling the sleeve, insert or take off the bit.

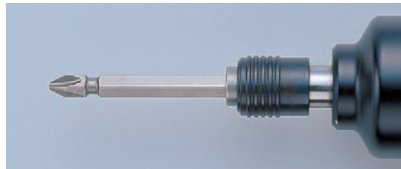
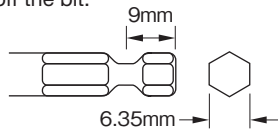

The model name suffixing (D) is the Quick-change driver anvil type.

Specifications (Shut-off Type)

Model	Capacity (Nominal Bolt Size)		Torque Range		Free Speed (Approx.) rpm	Overall Length less Socket or Bit (Approx.)		Weight less Socket or Bit				From Center to Outside (Approx.)		Sq. Drive or Hex. Size		Battery Voltage (Capacity)	Code
	mm	in	Nm	ft-lbs		mm	in	with battery		with no battery		mm	in	mm	in		
					kg			lb	kg	lb							
BP-T40D	5	No. 10	4.5-8	3.3-5.9	3300	200	7 7/8	1.4	3.08	1.15	2.53	27	1 1/16	6.35 Hex.	1/4 Hex.	10.8V (2.0Ah)	10A02
BP-T50D	6-8	1/4-5/16	6.5-13	4.8-9.6	3900	200	7 7/8	1.4	3.08	1.15	2.53	27	1 1/16	6.35 Hex.	1/4 Hex.	10.8V (2.0Ah)	10C02
BP-T60D	8	5/16	13-26	9.6-19.2	4800	205	8 5/64	1.6	3.52	1.25	2.75	27	1 1/16	6.35 Hex.	1/4 Hex.	14.4V (2.0Ah)	10E02
BP-T40	5	No. 10	4.5-8	3.3-5.9	3300	197	7 4/3	1.4	3.08	1.15	2.53	27	1 1/16	9.5 sq.	3/8 sq.	10.8V (2.0Ah)	10A12
BP-T50	6-8	1/4-5/16	7-15	5.1-11.1	3900	197	7 4/3	1.4	3.08	1.15	2.53	27	1 1/16	9.5 sq.	3/8 sq.	10.8V (2.0Ah)	10C12
BP-T60	8	5/16	13-26	9.6-19.2	4800	202	7 61/64	1.6	3.52	1.25	2.75	27	1 1/16	9.5 sq.	3/8 sq.	14.4V (2.0Ah)	10E12

*Torque Range is a guideline value. Please make tool selection appropriately in accordance with an actual application.
 *Battery or Battery Charger is not included. Please use corresponding models of Panasonic.

OPTION

Protector



Optional Tool Jackets

Size	Part Number	Used for
S	10C-840-1	BP-T40(D), BP-T50(D)
	10C-840-4	BP-T40(D)(RF8)/(TK), BP-T50(D)(RF8)/(TK)
	10D-840-2	BP-T40(D)(Z), BP-T50(D)(Z)
M	10E-840-1	BP-T60(D)
	10E-840-4	BP-T60(D)(RF8)/(TK)
	10F-840-2	BP-T60(D)(Z)

DERIVATIVE MODELS OF BP-T SERIES [SHUT-OFF TYPE]

Wireless RF8 Type / Z(ZigBee) Type (*)

*For information on the Radio Law in your country, please contact your nearest URYU distributor.

RF8 : Pokayoko configuration

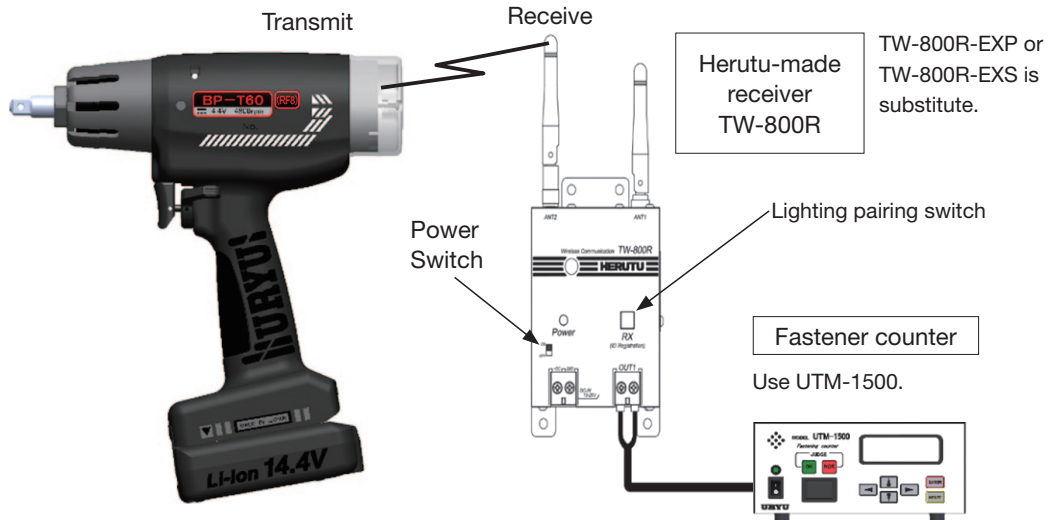

Z(ZigBee) : Pokayoko configuration

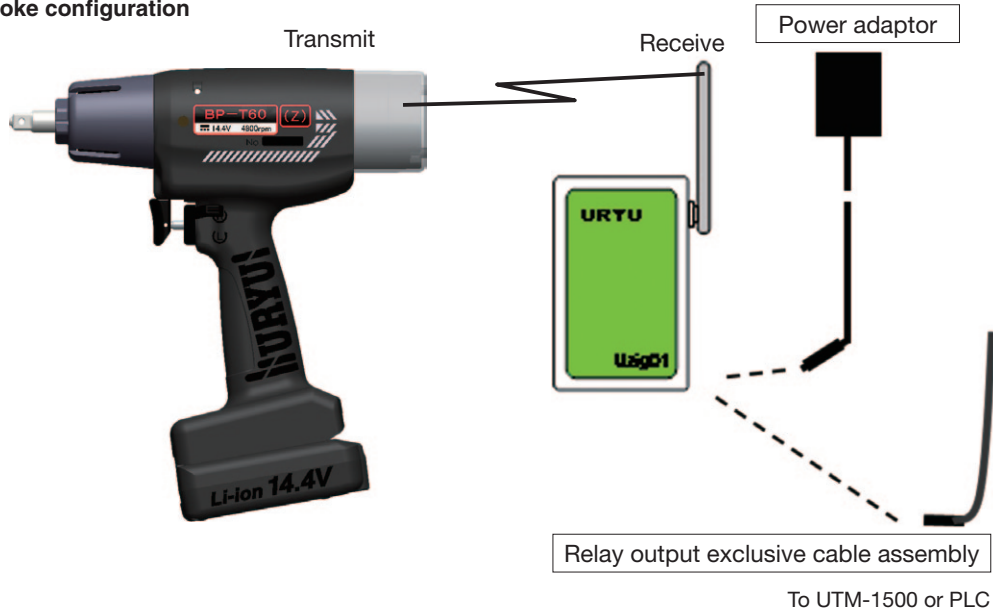

Specifications (Shut-off Type)

Model	Capacity (Nominal Bolt Size)		Torque Range		Free Speed (Approx.) rpm	Overall Length less Socket or Bit (Approx.)		Weight less Socket or Bit				From Center to Outside (Approx.)		Sq. Drive or Hex. Size		Battery Voltage (Capacity)	Code
	mm	in	Nm	ft-lbs		mm	in	with battery		with no battery		mm	in	mm	in		
					kg			lb	kg	lb							
BP-T40D(RF8)	5	No. 10	4.5-8	3.3-5.9	3300	207	8 5/32	1.4	3.08	1.15	2.53	27	1 1/16	6.35 Hex.	1/4 Hex.	10.8V (2.0Ah)	10A62
BP-T50D(RF8)	6-8	1/4-5/16	6.5-13	4.8-9.6	3900	207	8 5/32	1.4	3.08	1.15	2.53	27	1 1/16	6.35 Hex.	1/4 Hex.	10.8V (2.0Ah)	10C62
BP-T60D(RF8)	8	5/16	13-26	9.6-19.2	4800	212	8 11/32	1.6	3.52	1.25	2.75	27	1 1/16	6.35 Hex.	1/4 Hex.	14.4V (2.0Ah)	10E62
BP-T40(RF8)	5	No. 10	4.5-8	3.3-5.9	3300	204	8 1/32	1.4	3.08	1.15	2.53	27	1 1/16	9.5 sq.	3/8 sq.	10.8V (2.0Ah)	10A72
BP-T50(RF8)	6-8	1/4-5/16	7-15	5.1-11.1	3900	204	8 1/32	1.4	3.08	1.15	2.53	27	1 1/16	9.5 sq.	3/8 sq.	10.8V (2.0Ah)	10C72
BP-T60(RF8)	8	5/16	13-26	9.6-19.2	4800	209	8 15/64	1.6	3.52	1.25	2.75	27	1 1/16	9.5 sq.	3/8 sq.	14.4V (2.0Ah)	10E72
BP-T40D(Z)	5	No. 10	4.5-8	3.3-5.9	3300	218	8 37/64	1.4	3.08	1.15	2.53	27	1 1/16	6.35 Hex.	1/4 Hex.	10.8V (2.0Ah)	10B12
BP-T50D(Z)	6-8	1/4-5/16	6.5-13	4.8-9.6	3900	218	8 37/64	1.4	3.08	1.15	2.53	27	1 1/16	6.35 Hex.	1/4 Hex.	10.8V (2.0Ah)	10D12
BP-T60D(Z)	8	5/16	13-26	9.6-19.2	4800	223	8 25/32	1.6	3.52	1.25	2.75	27	1 1/16	6.35 Hex.	1/4 Hex.	14.4V (2.0Ah)	10F12
BP-T40(Z)	5	No. 10	4.5-8	3.3-5.9	3300	215	8 15/32	1.4	3.08	1.15	2.53	27	1 1/16	9.5 sq.	3/8 sq.	10.8V (2.0Ah)	10B22
BP-T50(Z)	6-8	1/4-5/16	7-15	5.1-11.1	3900	215	8 15/32	1.4	3.08	1.15	2.53	27	1 1/16	9.5 sq.	3/8 sq.	10.8V (2.0Ah)	10D22
BP-T60(Z)	8	5/16	13-26	9.6-19.2	4800	220	8 21/32	1.6	3.52	1.25	2.75	27	1 1/16	9.5 sq.	3/8 sq.	14.4V (2.0Ah)	10F22

*Torque Range is a guideline value. Please make tool selection appropriately in accordance with an actual application.
 *Battery or Battery Charger is not included. Please use corresponding models of Panasonic.

BP-T SERIES [SHUT-OFF TYPE]

Incomplete Job Detection (TK) Type

LED with red lighting tells you incomplete job (premature trigger off)

BOLT & NUT SETTERS



BP-T60D (TK)

FEATURES

- Squeeze trigger, and shut-off information LED will light red.
- Switch off the trigger before automatic shut-off, and the LED will continue lighting red for 3 seconds and go out.
- The LED lights green with 1 pulse buzzer sounding for automatic shut-off.

(Note) Automatic shut-off by retry repairing incomplete job error will light LED by switching green and red together.

Quick-change driver anvil type

On pulling the sleeve, insert or take off the bit.

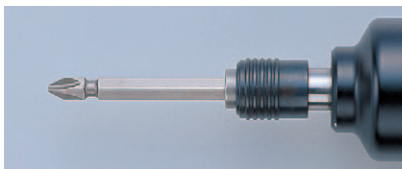
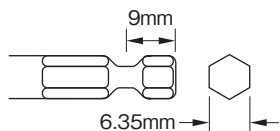

The model name suffixing (D) is the Quick-change driver anvil type.

Specifications (Shut-off Type)

Model	Capacity (Nominal Bolt Size)		Torque Range		Free Speed (Approx.)	Overall Length less Socket or Bit (Approx.)		Weight less Socket or Bit				From Center to Outside (Approx.)		Sq. Drive or Hex. Size		Battery Voltage (Capacity)	Code
	mm	in	Nm	ft-lbs	rpm	mm	in	with battery		with no battery		mm	in	mm	in		
								kg	lb	kg	lb						
BP-T40D(TK)	5	No. 10	4.5-8	3.3-5.9	3300	207	8 5/32	1.4	3.08	1.15	2.53	27	1 1/16	6.35 Hex.	1/4 Hex.	10.8V (2.0Ah)	10A82
BP-T50D(TK)	6-8	1/4-5/16	6.5-13	4.8-9.6	3900	207	8 5/32	1.4	3.08	1.15	2.53	27	1 1/16	6.35 Hex.	1/4 Hex.	10.8V (2.0Ah)	10C82
BP-T60D(TK)	8	5/16	13-26	9.6-19.2	4800	212	8 11/32	1.6	3.52	1.25	2.75	27	1 1/16	6.35 Hex.	1/4 Hex.	14.4V (2.0Ah)	10E82
BP-T40(TK)	5	No. 10	4.5-8	3.3-5.9	3300	204	8 1/32	1.4	3.08	1.15	2.53	27	1 1/16	9.5 sq.	3/8 sq.	10.8V (2.0Ah)	10A92
BP-T50(TK)	6-8	1/4-5/16	7-15	5.1-11.1	3900	204	8 1/32	1.4	3.08	1.15	2.53	27	1 1/16	9.5 sq.	3/8 sq.	10.8V (2.0Ah)	10C92
BP-T60(TK)	8	5/16	13-26	9.6-19.2	4800	209	8 15/64	1.6	3.52	1.25	2.75	27	1 1/16	9.5 sq.	3/8 sq.	14.4V (2.0Ah)	10E02

*Torque Range is a guideline value. Please make tool selection appropriately in accordance with an actual application.
 *Battery or Battery Charger is not included. Please use corresponding models of Panasonic.